



Access Statement

OeAD Building in
Ebendorferstraße 7
1010 Vienna

Contents

1.	Service chain	1
1.1.	Contact information.....	3
1.2.	How to get there by public transport	3
1.2.1.	Travelling by tram 43 or 44 to Landesgerichtsstraße stop – approximately 200 meters on foot	3
1.2.2.	Travelling by underground line U2 to Schottentor station – approximately 350 meters on foot	4
1.3.	Travelling by car, parking, arrival.....	4
1.4.	Entrance to the OeAD building, Ebendorferstraße 7.....	5
1.5.	Access, entrance to the OeAD building	6
1.6.	Overview: OeAD building in Ebendorferstraße 7	6
1.7.	Entrance area on the ground floor	7
1.7.1.	Main entrance and access to the staircase to the upper floors and reception....	7
1.7.2.	Access to the OeAD Regional Office	8
1.7.2.1.	Stair lift to the Regional Office	8
1.7.2.2.	Data regarding the accessible stair lift.....	9
1.7.3.	Entrance to the four function rooms on the lower ground floor	10
1.7.3.1.	Stair lift to the function rooms on the lower ground floor.....	10
1.7.3.2.	Data regarding the accessible stair lift.....	10
1.7.4.	Access to OeAD student housing.....	12
1.8.	First floor with reception, meeting rooms 1.11 and 1.12.....	13
1.8.1.	What can you find on the first floor?.....	13
1.8.2.	Accessible lift to the upper floors	13
1.8.2.1.	Data regarding the accessible lift:.....	13
1.8.3.	Reception on the 1 st floor	13
1.8.4.	Meeting room 1.12. on the 1 st floor	14
1.9.	Accessible toilet in room 1.06. on the 1 st floor.....	15
1.9.1.	Data regarding the accessible toilet on the first floor	16
1.10.	Lower ground floor with function rooms 1, 2, 3 and 4.....	16

1.10.1. What can you find on the lower ground floor?	16
1.10.2. Function room 1.....	17
1.10.2.1. Data regarding function room 1.....	17
1.10.2.2. Technical equipment.....	17
1.10.3. Function room 2 and/or function room 3.....	18
1.10.3.1. Data regarding function rooms 2 and 3	18
1.10.3.2. Technical equipment.....	18
1.10.4. Function room 4.....	19
1.10.4.1. Data regarding function room 4.....	19
1.10.4.2. Technical equipment.....	19
1.11. Accessible toilet on the lower ground floor	19
1.11.1. Data regarding the accessible toilet:	20
1.12. Escape routes	20
1.13. Additional information.....	21
1.14. Details	21

1. Service chain



www.oead.at

The service chain serves as mental aid for the OeAD's publicly accessible offers for events and counselling sessions.

The service chain describes the services offered by the OeAD, from first information, how to get to the OeAD, and what is offered on the premises of the OeAD.

The OeAD service chain includes the following elements:

- + Contact information
- + How to get there
- + Entrance
- + Lifts, stair lifts
- + 1st floor: reception, waiting area, meeting room 1.12, accessible toilet
- + Lower ground floor, function rooms 1 to 4, accessible toilet
- + Escape routes

In the following chapters the elements of the service chain will be described in detail.

These descriptions are to help you to assess whether or not you can use the services that the OeAD offers.

1.1. Contact information

The contact person for questions regarding accessibility at the OeAD is Florian Gerhardus florian.gerhardus@oead.at, phone +43 1 53408-258.

Address: Ebendorferstraße 7 in 1010 Vienna

The OeAD's reception staff provide on-site support. If you need support, call +43 1 53408-0.

For further information see www.oead.at/en/accessibility-statement

1.2. How to get there by public transport

1.2.1. Travelling by tram 43 or 44 to Landesgerichtsstraße stop – approximately 200 meters on foot

Take tram 43 or 44 to Landesgerichtsstraße stop. Cross Universitätsstraße (traffic lights with signal) and turn slightly left to the corner of Ebendorferstraße. Walk along Ebendorferstraße until you get to number 7.

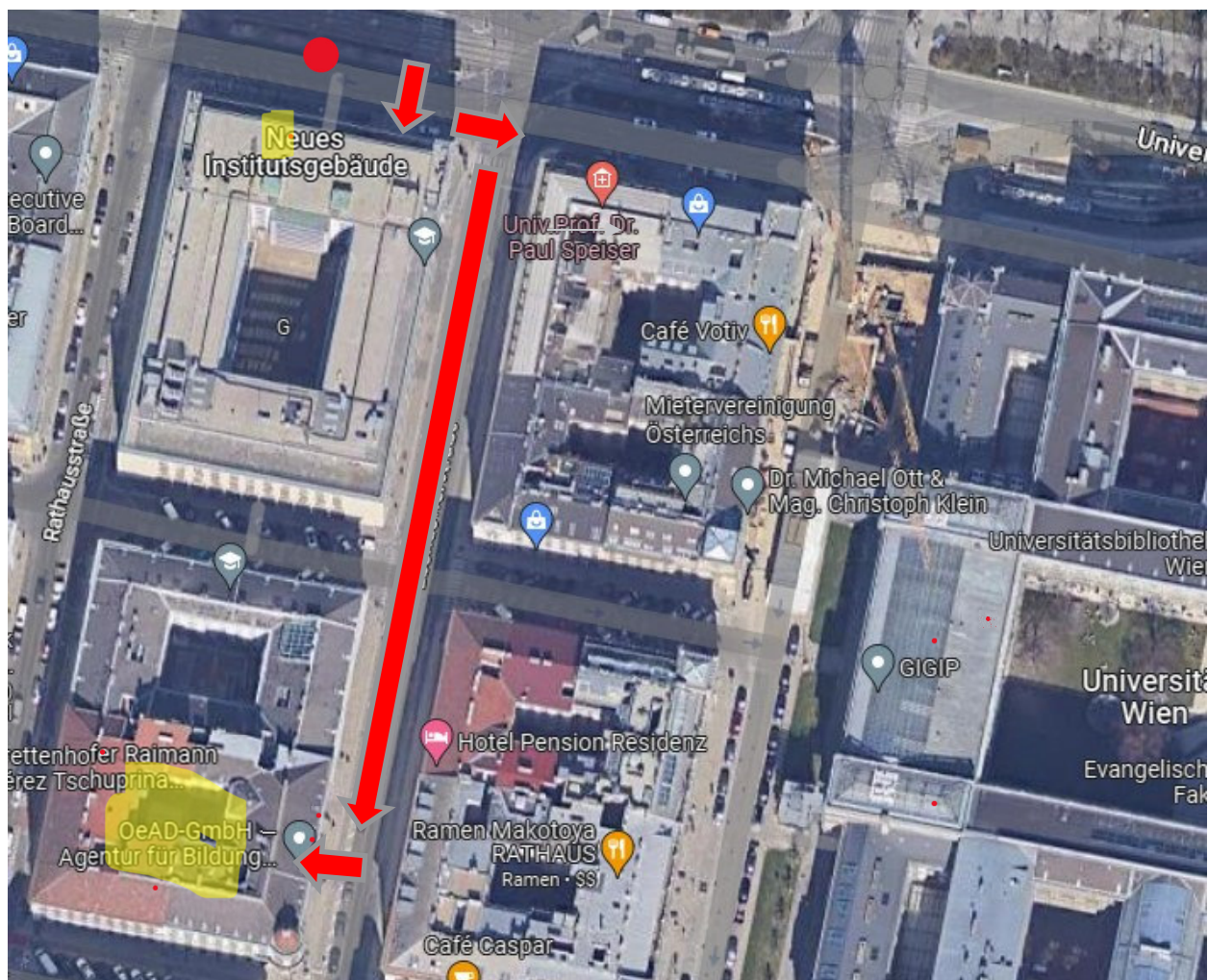

Figure 1: Walking route from the tram stop Landesgerichtsstraße to the OeAD building in Ebendorferstraße 7.

1.2.2. Travelling by underground line U2 to Schottentor station – approximately 350 meters on foot

You can get to Schottentor station by the tram lines 1, 71, D, 37, 38, 40 or 41, underground line U2 or bus 1A. Take the University exit (“Universität”) (lift available). At the exit of the lift there is a stop for the tram lines 43 and 44. For a description see the paragraph above at 1.2.1. regarding Landesgerichtsstraße stop.

You can also walk from here: From the exit of the lift walk left to the University of Vienna building. Turn right and walk along Universitätsstraße to the corner of Ebendorferstraße and cross it (2 traffic lights with signal). Turn left and walk along Ebendorferstraße until you get to number 7.

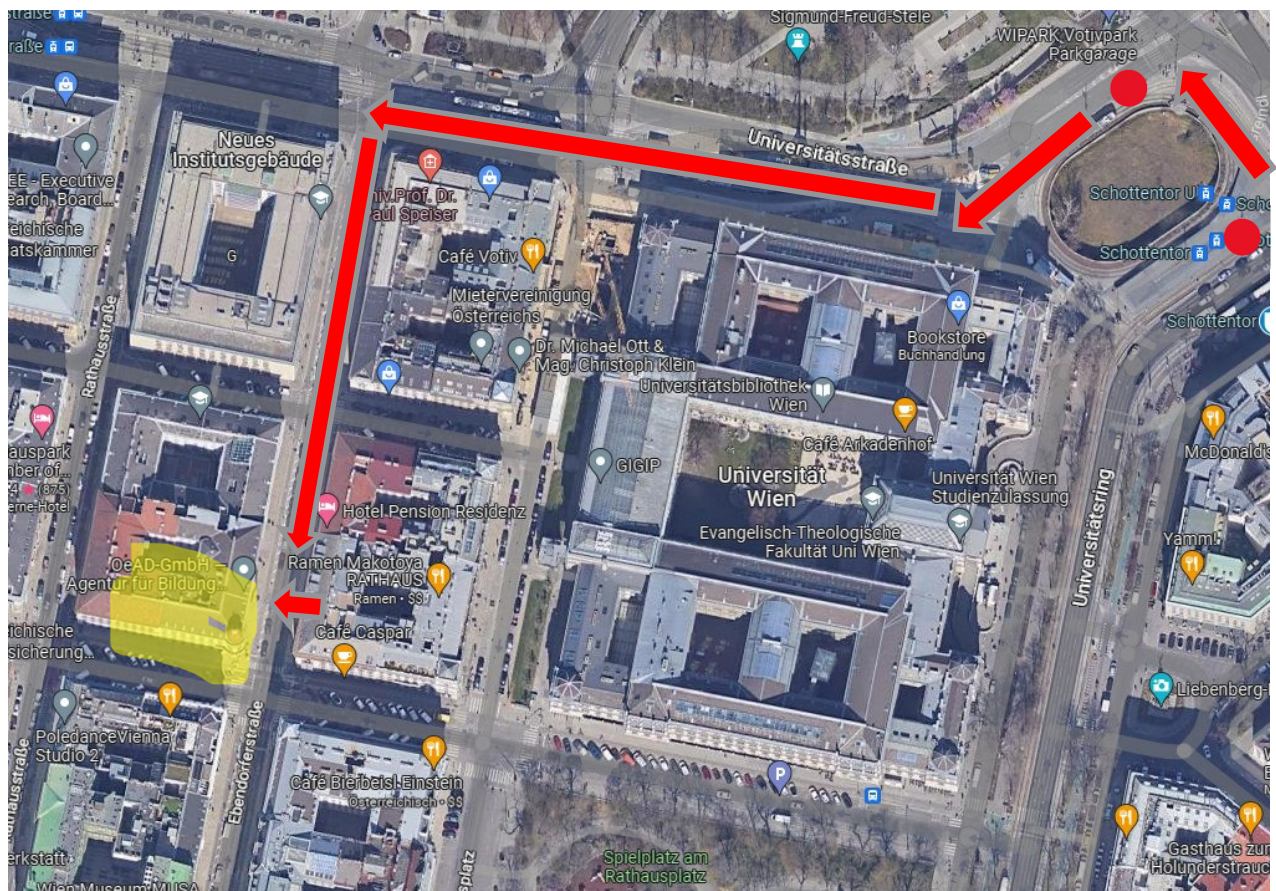

Figure 2: How to walk from Schottentor station to the OeAD building in Ebendorferstraße 7.

1.3. Travelling by car, parking, arrival

The OeAD's Ebendorferstraße 7 location is in the city of Vienna's fee-paying short-stay parking area (weekdays from 9 a.m. to 10 p.m.).

There are no customer parking spaces in front of the OeAD building. There are parking spaces right in front of the entrance of the building but they are restricted to residents with parking permits. Adjacent to the OeAD building, in Grillparzerstraße and Liebiggasse, there are public parking spaces that do not require a parking permit.

1.4. Entrance to the OeAD building, Ebendorferstraße 7



Figure 3: Entrance to the OeAD building in Ebendorferstraße 7

The way from the surrounding public parking spaces to the entrance of the OeAD building is level with a paved pavement.



Figure 4: OeAD entrance Ebendorferstraße 7 in Vienna

There is a ramp connecting the roadway of Ebendorferstraße to the pavement in front of the OeAD's entrance door. There is no tactile guidance system to the main entrance.

1.5. Access, entrance to the OeAD building

During opening hours you enter the OeAD building via an automatic sliding glass door. It is 1 m 59 cm wide. The entrance is level. Still outside the sliding glass door on the wall on the right there is a call button with an intercom. If you need assistance, please press the button. You will then be connected to the reception staff during opening hours. The reception desk is staffed Mondays to Thursdays from 8 a.m. to 5 p.m. and on Fridays from 8 a.m. to 4 p.m. You can also reach the reception by telephone: +43 1 53408-0.

1.6. Overview: OeAD building in Ebendorferstraße 7

The entrance area is located on the ground floor. From here you can reach all floors of the building.

The event rooms 1 to 4 are located in the basement. An accessible toilet can also be found there.

The central reception, the meeting rooms 1.11 and 1.12 and another accessible toilet are located on the first floor.

In the following chapters you will find a detailed description of the different parts of the building and their accessibility.

1.7. Entrance area on the ground floor

There is no threshold in the entrance area after the sliding glass door. There is no tactile floor information. Attention: Don't go straight ahead down the stairs. There is no entrance there.

1.7.1. Main entrance and access to the staircase to the upper floors and reception



Figure 5: Entrance area; the arrow shows the main entrance and access to the staircase with accessible lift to the upper floors and the reception.

For more information about this entrance see section 1.8.

1.7.2. Access to the OeAD Regional Office

From the entrance area you can get to the OeAD Regional Office on the right via an accessible staircase with stair lift or via 15 steps.



Figure 6: Entrance area, stair lift to the Regional Office on the right.

1.7.2.1. Stair lift to the Regional Office

You will need a Euro Key to use the stair lift. If you do not have one, you can request one in advance at the reception or at the OeAD Regional Office. To get assistance please inform your contact person at the OeAD in advance and/or call +43 1 53408-0.

Please note: The control panel for this stair lift is located on the wall opposite, as marked with a red arrow in the picture.



Figure 7: Entrance area, Euro Key for the stair lift on the other side of the entrance.

1.7.2.2. Data regarding the accessible stair lift

Width of the stairway next to the stair lift: 1 m 56 cm
Height of the steps: 13 cm
Tread surface of the steps: 37 cm
Handrail: height: 90 cm
Maximum capacity: 300 kg
Brand: Ganser, Type GTL30

1.7.3. Entrance to the four function rooms on the lower ground floor



Figure 8: entrance area, entrance to function rooms 1 to 4

Opposite the main entrance is the entrance to the function rooms 1 to 4. The arrow pointing to the left indicates the glass door entrance to the accessible stair lift to the function rooms 1, 2, 3 and 4 on the lower ground floor. You will get to the stair lift after passing through the hinged glass door. It has to be opened manually. You now descend the 12 steps (or take the stair lift) and get to another glass door that is 1 m 25 cm wide.

1.7.3.1. Stair lift to the function rooms on the lower ground floor

After passing through the glass door you will get to the stair lift. You will need a Euro Key to use the stair lift. If you do not have one, you can request one in advance from the reception or the OeAD Regional Office. To get assistance please inform your contact person at the OeAD in advance and/or call +43 1 53408-0.

1.7.3.2. Data regarding the accessible stair lift

The door is 1 m 2 cm wide, and 1 m 65 cm when fully opened. It is a hinged door that is opened and closed manually. There is an 80 cm lateral approach area in front of the door.

There is a manoeuvre space of at least 150 x 150 cm before and after the stair lift (entrance and exit). The control panel for the stair lift is located at a height of 96 cm.

Width of the stairway next to the stair lift: 1 m 56 cm

Height of the steps: 13 cm

Tread surface of the steps: 37 cm

Handrail: height: 90 cm

Maximum capacity: 300 kg

Brand: Ganser, Type GTL30



Figure 9: Stair lift to the lower ground floor

1.7.4. Access to OeAD student housing



Figure 10: Entrance area, stairs to OeAD student housing – not wheelchair accessible

Opposite the OeAD Regional Office is OeAD student housing. The stairs marked with a red arrow in the picture above lead to OeAD student housing. The staircase is not wheelchair accessible.

If you want to use services of OeAD student housing, please make an appointment in advance by calling +43 1 53408-800.



Figure 11: Entrance area, access to the staircase with accessible lift to the upper floors

The arrow pointing to the right indicates the way to the staircase and the accessible lift to the upper floors.

1.8. First floor with reception, meeting rooms 1.11 and 1.12

1.8.1. What can you find on the first floor?

- Reception
- Meeting rooms 1.11 and 1.12 (accessible)
- Accessible toilet

The reception is located on the first floor of the OeAD building. From the entrance area go through the glass door on the right to the accessible lift. The glass door is a hinged door that opens outwards. You must open it manually. The glass door is at least 1 m 2 cm wide, the maximum width is 1 m 65 cm.

Once you pass through the door you will be in the stairwell and in front of the accessible lift, which is immediately to your left, in the middle of the stairwell. There is no tactile floor information.

1.8.2. Accessible lift to the upper floors

1.8.2.1. Data regarding the accessible lift:

Exterior:

Height of the call button for the accessible lift (the one on the left): 1 m 10 cm. Automatic sliding doors: width: 85 cm

Inside the cabin:

Height of the push button for the 3rd floor: 1 m 2 cm

Width: 88 cm

Depth: 1 m 96 cm

The lift has buttons to all floors with Braille lettering. There are no tactile signs. There is no handrail.

1.8.3. Reception on the 1st floor

The reception is open on Mondays to Thursdays from 8 a.m. to 5 p.m. and on Fridays from 8 a.m. to 4 p.m. You can reach the reception by telephone on +43 1 53408-0 and they offer assistance with entering and leaving the building, if requested.

The reception is located on the first floor and can be reached by a lift. The entrance door is on the right, coming from the lift. There are no tactile floor information or textured surfaces in front of the doors.

The hinged glass door has to be opened manually; it opens outwards towards the stairwell. The door opens 90 degrees outwards. If you need assistance, please contact the reception staff.

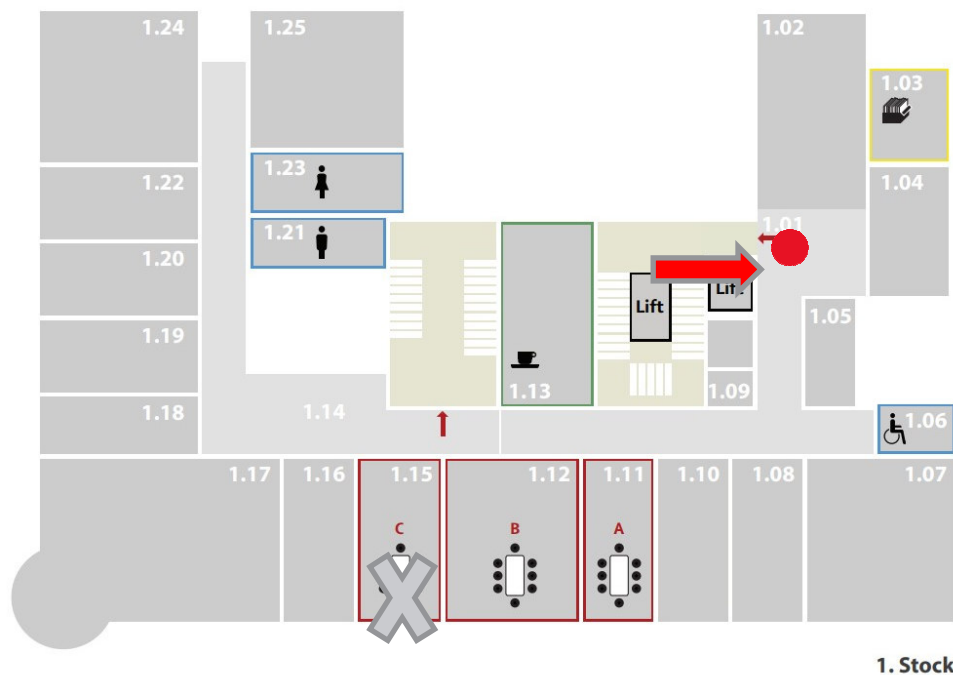

Figure 12: Room plan Ebendorferstraße 7, 1st floor, reception

After passing through the entrance door you will see the reception desk to your left. Please sign in there. Straight ahead you will come to the waiting area in the open room 1.04. It is equipped with chairs with armrests and backrests and a clothes rack with a height of 1m 55cm. The aisle in the waiting area is 1 m 33 cm wide.

1.8.4. Meeting room 1.12. on the 1st floor

Opposite the reception desk starts the corridor to the meeting room 1.12. Go along this corridor and turn right at the end. The meeting room 1.12 is approximately 15 m down the corridor on the left-hand side. You enter the room through a wooden double door. Please note that there is a 2-cm threshold at the entrance to the meeting room.

Width of the doorway: at least 59 cm, and 1 m 1 cm if both door leaves are open.

Seating is adaptable. The chairs are equipped with backrests. The tables are wheelchair accessible. The room is equipped with power sockets.

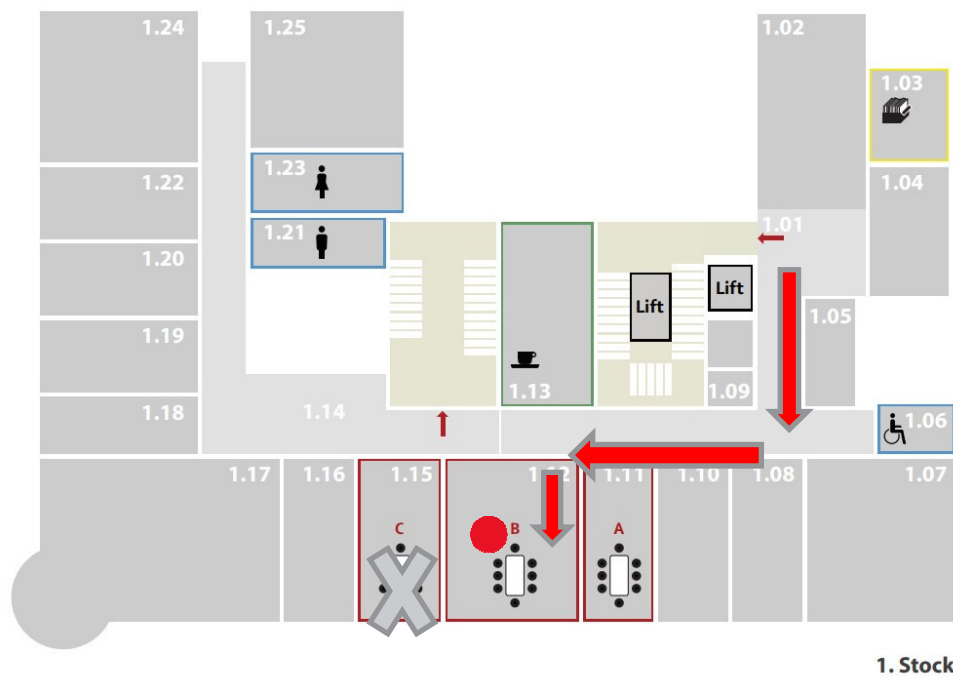

Figure 13: Room plan Ebendorferstraße 7, 1st floor meeting room 1.12

1.9. Accessible toilet in room 1.06 on the 1st floor

Opposite the reception desk on the first floor starts the corridor to the accessible toilet in room 1.06. Go along the corridor and turn left at the end.

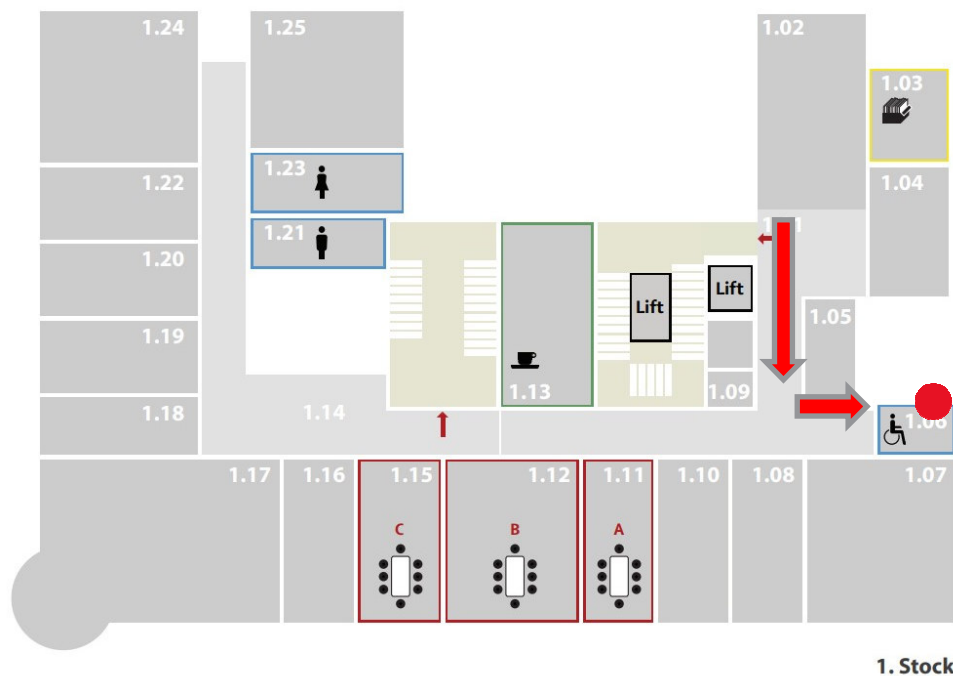

Figure 14: Accessible toilet in Ebendorferstraße 7, 1st floor, room 1.06

From the meeting room 1.12 turn right and go straight ahead to the end of the corridor.

You enter the toilet through a hinged door that opens outwards; you have to open it by hand.

1.9.1. Data regarding the accessible toilet on the first floor

Depth of the toilet seat: 45/69 cm

Height of the toilet seat: 47 cm

Toilet accessible by wheelchair from the left side.

Equipped with grab rails (L-shaped grab rail on the wall side and fold-down rail). The turning radius is 1 m 50 cm. The washbasin is wheelchair accessible.

Height of the controls for the fittings: 85 cm.

The disinfectant is at a height of 1 m 45 cm.

There is an emergency alarm cord, which will connect you to the reception staff.

1.10. Lower ground floor with function rooms 1, 2, 3 and 4

The OeAD has four function rooms on the lower ground floor. They are directly accessible from the entrance area.

1.10.1. What can you find on the lower ground floor?

- Function room 1, function room 2, function room 3 and function room 4
- Accessible toilet

1.10.2. Function room 1

The entrance to function room 1 is accessible. The entrance is located in the entrance area on the left. Function room 1 is the largest function room at the OeAD. After leaving the stair lift you will find another glass door that opens outwards (to be opened manually).

Passage width of the door: 1m 25 cm.

Turn right and then immediately right again.

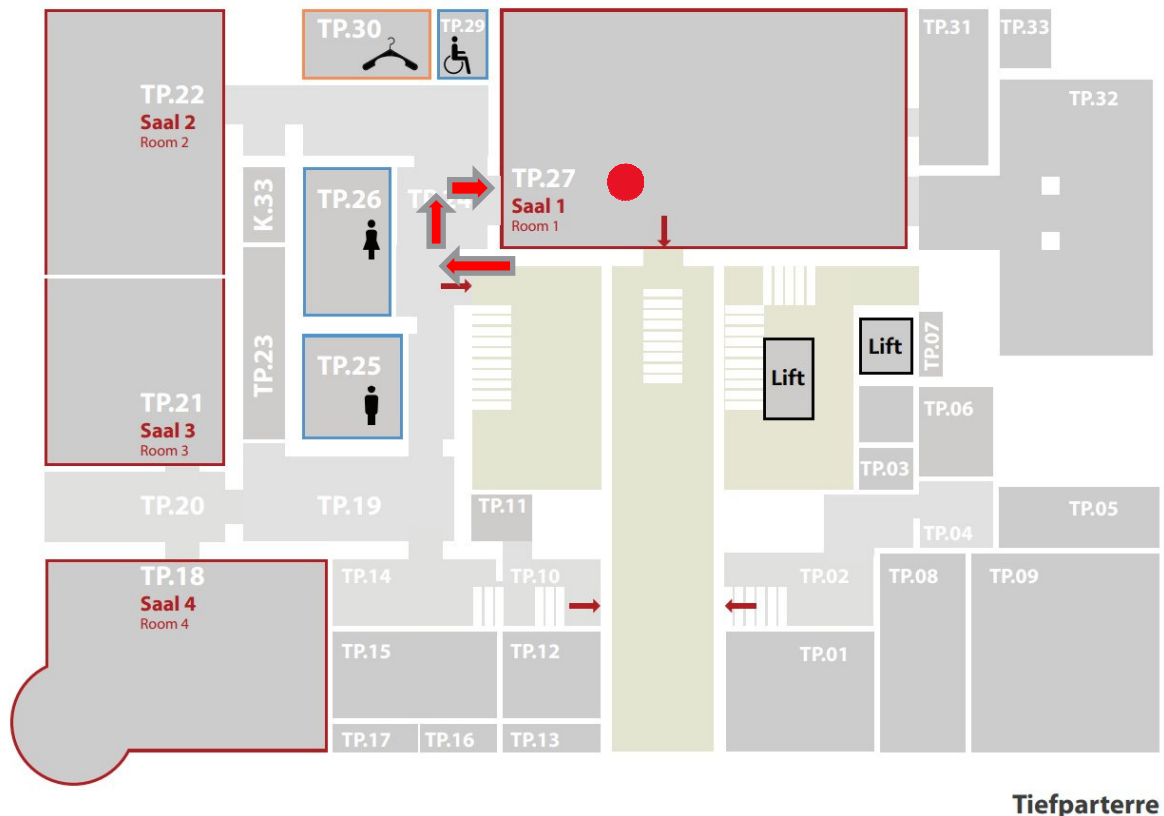

Figure 15: Room plan Ebendorferstraße 7, lower ground floor, function rooms

1.10.2.1. Data regarding function room 1

Passage width of the door: 1 m 20 cm

Desk height (bottom edge of the desktops): 70 cm

Seating is adaptable. Chairs are equipped with backrests. Desks are wheelchair accessible.

The room is equipped with power sockets.

1.10.2.2. Technical equipment

The room does not have an inductive hearing system. Lighting is glare-free.

1.10.3. Function room 2 and/or function room 3

The function rooms 2 and 3 can be used separately or together.

After leaving the stair lift you will find another glass door that opens outwards (to be opened manually). Turn right, go straight ahead and at the end of the corridor turn left. At the end of this corridor is the entrance to the function room 2.

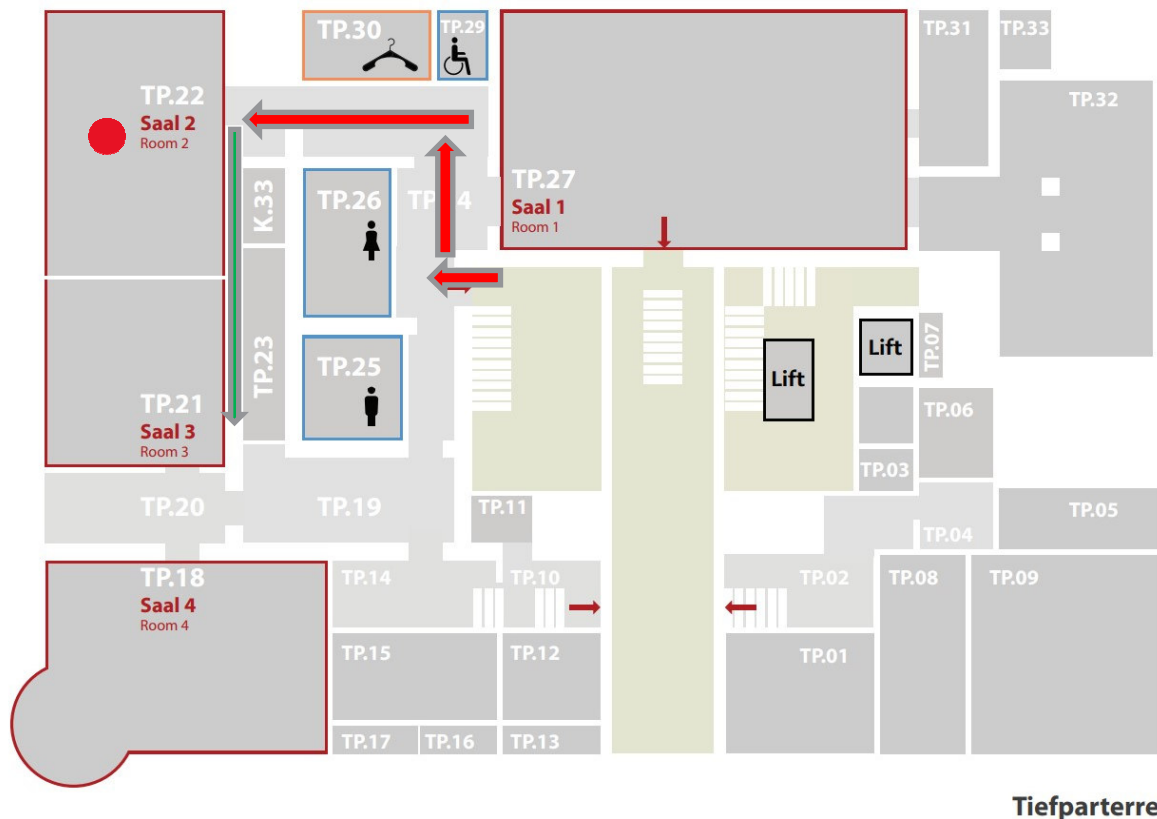

Figure 16: Room plan Ebendorferstraße 7, lower ground floor, function rooms 2+3

To get to the function room 3 first go to function room 2 by the way mentioned above. At the entrance to function room 2 continue to the left as indicated in green in the picture. The corridor is very narrow and only 72 cm wide at its narrowest point.

1.10.3.1. Data regarding function rooms 2 and 3

Passage width of the door: 1m 20 cm

Desk height (bottom edge of the desktops): 70 cm

Seating is adaptable. Chairs are equipped with backrests. Desks are wheelchair accessible.

The room is equipped with power sockets.

1.10.3.2. Technical equipment

The room does not have an inductive hearing system. Lighting is not glare-free.

1.10.4. Function room 4

After leaving the stair lift and going through the glass door turn left. At the end of the corridor turn right. After the passage (width at the narrowest point: 78 cm) you will find the entrance to function room 4 on the left.

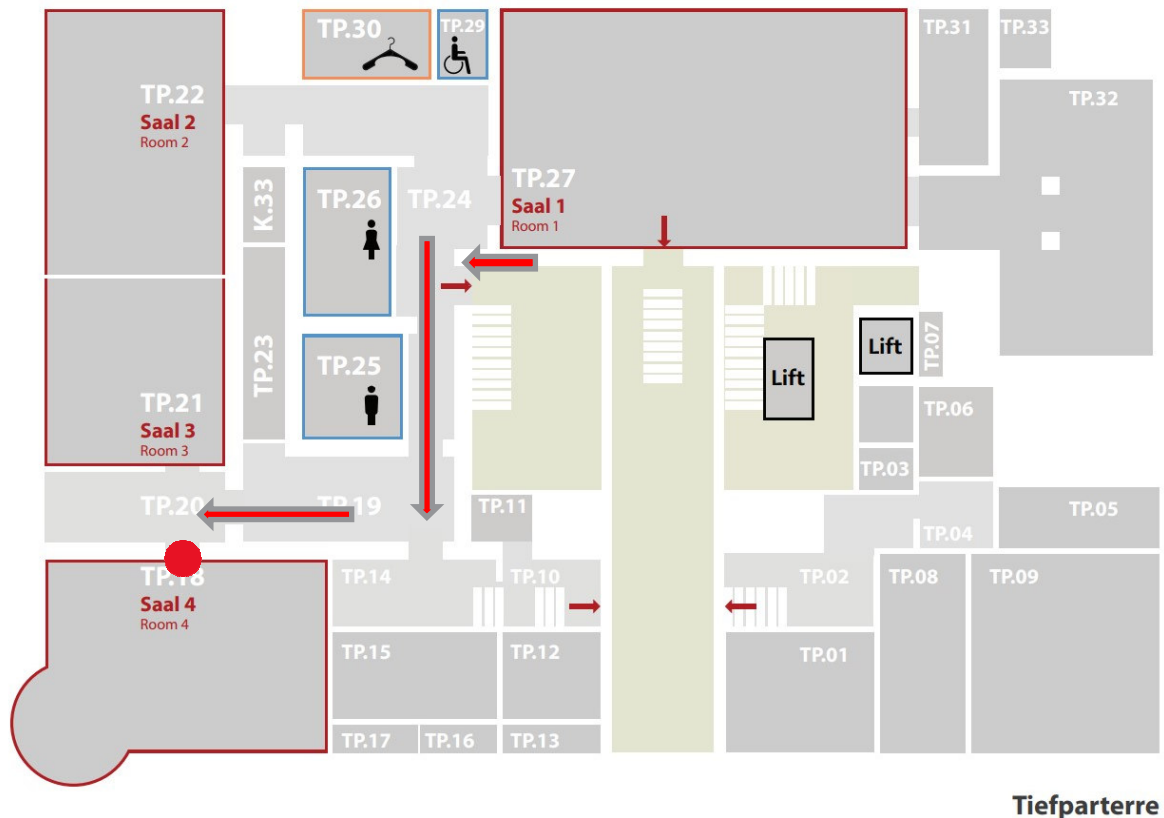

Figure 17: Room plan Ebendorferstraße 7, lower ground floor, function room 4

1.10.4.1. Data regarding function room 4

Passage width of the door: 1 m 38 cm

Desk height (bottom edge of the desktops): 70 cm

Seating is adaptable. Chairs are equipped with backrests. Desks are wheelchair accessible.

The room is equipped with power sockets.

1.10.4.2. Technical equipment

Room 4 does not have an inductive hearing system. Lighting is not glare-free.

1.11. Accessible toilet on the lower ground floor

There is an accessible toilet on the lower ground floor in room TP 29 close to the entrance to function room 1.

From the exit of the stair lift you will reach the accessible toilet by going through the glass door and then turning right and straight ahead along the corridor.

You will enter the toilet through a hinged door to be opened manually. The door opens outwards.

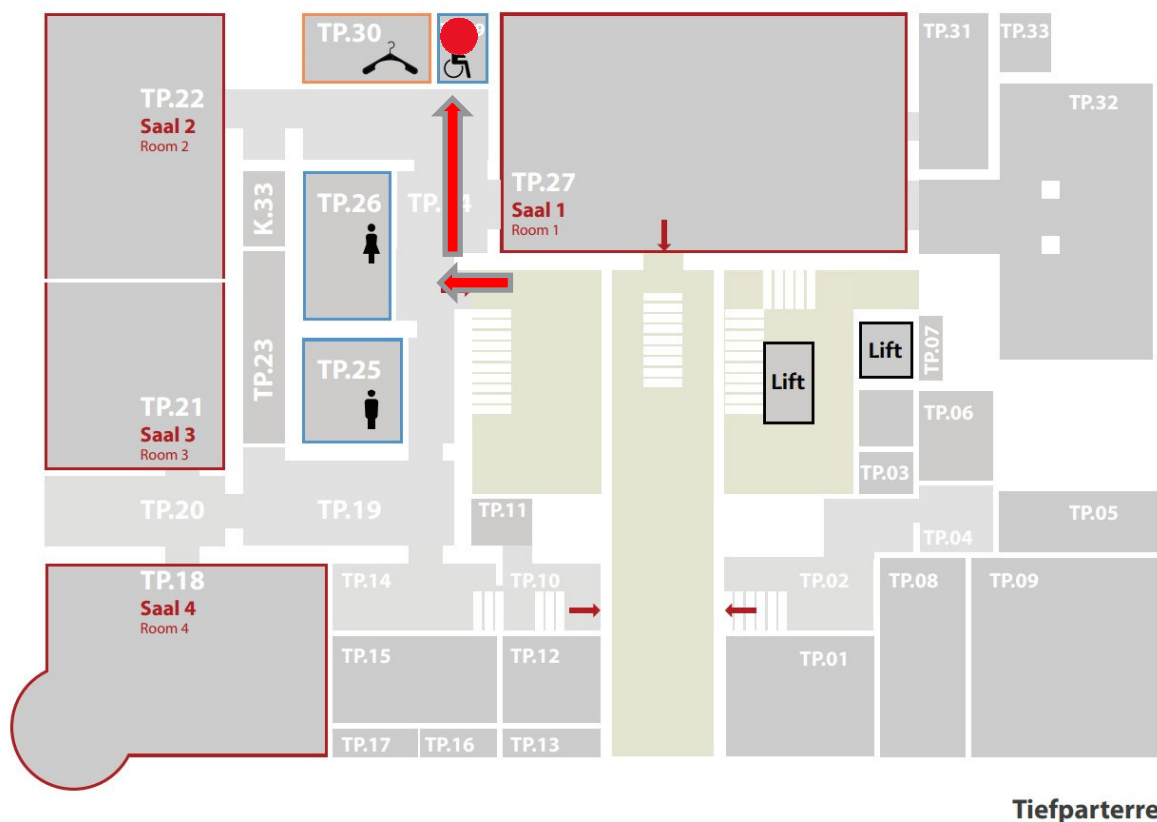

Figure 18: Room plan Ebendorferstraße 7, lower ground floor, accessible toilet

1.11.1. Data regarding the accessible toilet:

Depth of the toilet seat: 45/69 cm

Height of the toilet seat: 47 cm

Toilet accessible by wheelchair from the left side.

Equipped with grab rails (L-shaped grab rail on the wall side and fold-down rail). The turning radius is 150 cm.

The washbasin is wheelchair accessible

Height of the controls for the fittings: 85 cm

The disinfectant is at a height of 1 m 45 cm.

There is an emergency alarm cord, which will connect you to the reception staff.

1.12. Escape routes

There is an escape route plan on each floor of the OeAD building. There are signs indicating the fire extinguishers and the escape routes are marked with green illuminated signs.

1.13. Additional information

Assistance dogs are allowed.

Unfortunately we do not have any staff members who speak Austrian sign language.

1.14. Details

The Access Statement was created on 2 May 2023 and reviewed by Peter Gaunerstorfer and Ursula Hilmar on 23 May 2023.

Further update on: _____ by: _____